



Features :

- True RMS Measurement
- Linear Scale
- Knife Edge Pointer
- Grey Lexan Housing
- Panel Mounting

Certification : CE

Scale and Pointer

| | |
|-----------------------|----------------------------------|
| Pointer | Knife - edge pointer |
| Pointer deflection | 0 to 90° |
| Scale characteristics | Linear scale |
| Scale length | AM-Hz-2 : 63mm AM-Hz-3 : 97mm |

Electrical Specifications

| | |
|--------------------------------|-----------------------|
| Measured Parameters | Frequency |
| Measuring Range | 45 to 65 Hz |
| Overload Capacity Continuously | 1.2 times continuous |
| Power Consumption | <2VA |
| Accuracy | Class 1 |
| Dielectric test | 2 kV AC for 1 Minute |
| Enclosure code | IP42 IP56 for back |
| Rated insulation voltage | 500V DC for 1 min |

Environmental Conditions

| | |
|-----------------------|-------------------|
| Operating temperature | 0°C to 60°C |
| Storage temperature | -20°C to 60°C |
| Relative humidity | upto 75% |
| Shock resistance | 15gn, 11 ms |
| Vibration resistance | 10-55-10Hz/0.15mm |
| Pollution degree | 2 |

Mechanical Specifications

| | |
|-----------------|--|
| Case details | Moulded casing |
| Case material | Lexan – Polycarbonate |
| Front facia | Glass |
| Color of bezel | Black |
| Position of use | Vertical |
| Panel fixing | Clamps |
| Mounting | Panel Mounting |
| Terminals | Hexagon studs, M4 screws and clamps M3 |
| Weight | AM-Hz-2 : 0.16 kg AM-Hz-3 : 0.23 Kg |
| Dimensions | AM-Hz-2 : 72x72mm AM-Hz-3 : 96x96mm |

Dimensions (All are in mm)

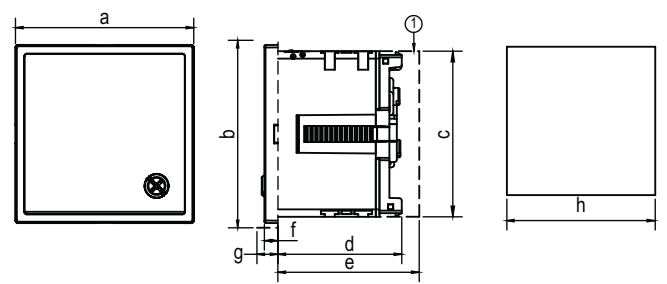

| Product | 72x72 | 96x96 |
|--------------------|-------|-------|
| Dimensions (in mm) | | |
| a | 72 | 96 |
| b | 74.50 | 98.50 |
| c | 67 | 90.50 |
| d | 50 | 50 |
| e | 60 | 60 |
| f | 5.50 | 5.50 |
| g | 8 | 8 |
| h | 68 | 92 |

Optional parts :

- 1 - Back Cover
- 2 - IP65 : Cover for all type of AM series

Terminal Connections

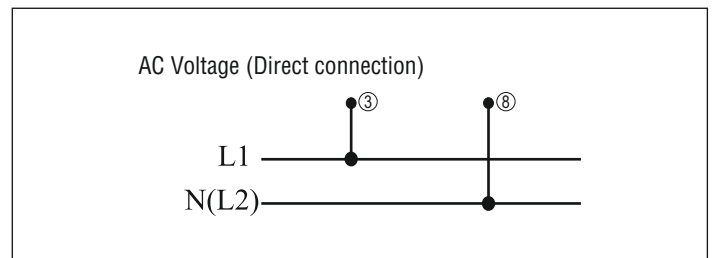

Compliance

| Applicable EMI / EMC Standards | | |
|--------------------------------|----------------|--|
| Product Standard : IEC 60051-2 | | |
| Category | | Standards Compliance |
| ESD Immunity | IEC 61000-4-2 | Contact Discharge : 4kV (Criteria B) Air Discharge : 8kV (Criteria B) |
| Surge Immunity | IEC 61000-4-5 | 0.5kV (for L-L) (Criteria B) |
| Radiated Susceptibility | IEC 61000-4-2 | 800MHz to 1GHz (10V/m) (Criteria A) 1.4GHz to 2GHz (3V/m) (Criteria A) 2GHz to 2.7GHz (1V/m) (Criteria A) |
| Conducted Susceptibility | IEC 61000-4-6 | 3V (Criteria A) |
| PFMF | IEC 61000-4-8 | 30 A/M (50Hz, 60Hz) (Criteria A) |
| Voltage Dips and Interruptions | IEC 61000-4-11 | VDI : 0% during 1 cycle (Criteria B), 40% during 10 / 12 cycles (Criteria C) 70% during 25 / 30 cycles (Criteria C) Short Interruptions : 0% during 250 / 300 cycles (Criteria C) |
| Electrical Fast Transient | IEC 61000-4-4 | 1kV (Criteria B) |

Ordering Information

| Product Code (Meters Without Dial Plates) | Certification |
|--|---------------|
| AM-Hz-3-45-65-440V | --- |
| AM-Hz-3-45-65-220V | --- |
| AM-Hz-2-45-65-440V | --- |
| AM-Hz-2-45-65-220V | --- |
| AM-Hz-3-45-65-440V-CE | --- |
| AM-Hz-3-45-65-220V-CE | --- |
| AM-Hz-2-45-65-440V-CE | --- |
| AM-Hz-2-45-65-220V-CE | --- |